

2 BEDROOM APARTMENT FOR SALE IN JUMEIRAH VILLAGE TRIANGLE - £253,575*

 Bedrooms: 2

 Build: 87m²

 Pool:

 Bathrooms: 3

 Plot: m²

 Ref: 658277

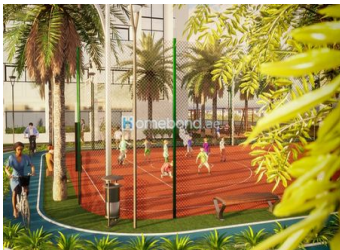
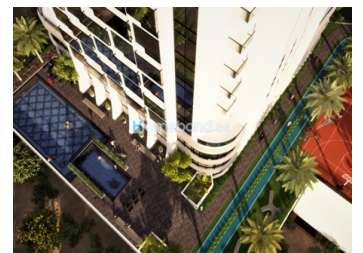

Property Description

Located in Jumeirah Village Triangle, a new residential building, Tiger Cloud, is offering a unique combination of luxury living and convenient commute to anywhere in Dubai. The apartments in Tiger Cloud would offer the rarity of high-floor views in the middle of low-rise community, making it an ultimate destination for those loving to wake up to amazing views from high above.

Completion Feb 2025
Payment plan: 80/20 | 2yrs Post handover
Down Payment – 20%

During construction- 40%

Handover- 20%

After move in- 20%

!!Few Units Left!!

Hurry Up!!

Key Highlights-

A development that provides you ease of life

Apartments in various sizes and configuration<...